

CANADIAN PECULIAR

GROUP 3

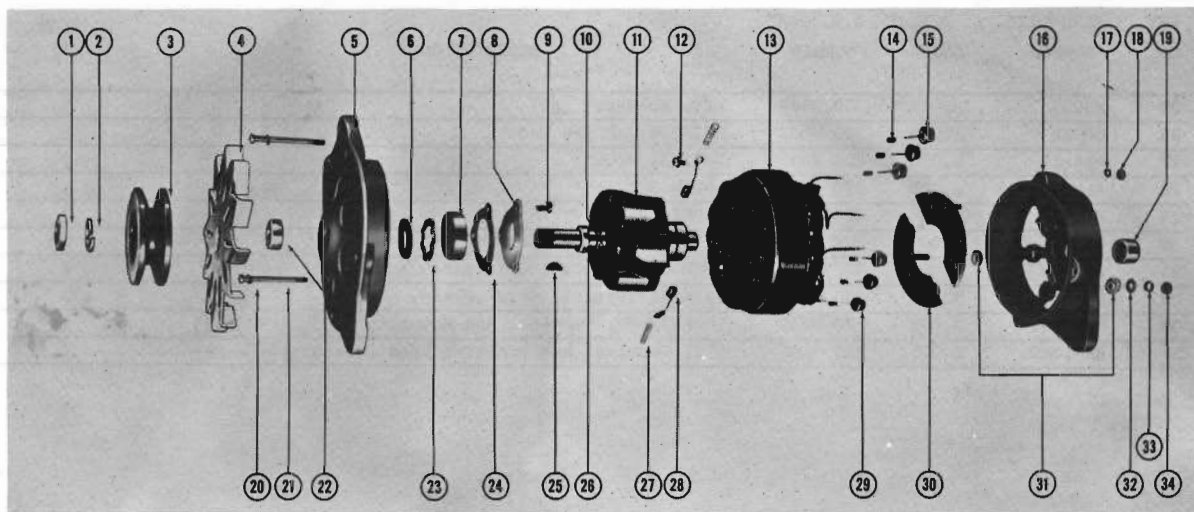

ALTERNATOR

A.M. NO. 316 9168 (34 Amp.) 163-164 01-10-80
 A.M. NO. 317 9259 (34 Amp.) 165 01 (LHE)(OHV-196): 165 10-80 (V8)
 A.M. NO. 316 9474 (40 Amp.) 163-164 01-10-80: 165 01 (LHE)(OHV-196):
 165 10-80 (V8)

AUTO-LITE NO. ALK-5101
 AUTO-LITE NO. ALK-5001C
 AUTO-LITE NO. ALE-5101A

| KEY NO. | AUTO-LITE NUMBER | A.M. GROUP | A.M. PART NUMBER | DESCRIPTION | QUAN. REQ. |
|---------|------------------|------------|------------------|---|------------|
| 1 | GBM-21B | 3.010 | 311 2796 | NUT, Rotor Shaft Drive End (Replaces 311 8776) | 1 |
| 2 | 12X-864 | 3.010 | 311 8777 | LOCKWASHER, Rotor Shaft Drive End Nut | 1 |
| 3 | PU-585 | 3.010 | 320 9013 | PULLEY, Drive | 1 |
| 4 | PU-625 | 3.010 | 320 9014 | FAN, Ventilating (Less Pulley)(34 Amp.) | 1 |
| 4 | PU-1605 | 3.017 | 320 9041 | FAN, Ventilating (Less Pulley)(40 Amp.) | 1 |
| 5 | ALE-1003G | 3.005 | 320 9015 | HEAD, Drive End (34 Amp.) | 1 |
| 5 | ALE-1003 | 3.005 | 320 9052 | HEAD, Drive End (40 Amp.) | 1 |
| 7 | X-3416 | 3.005 | 320 9016 | BEARING, Ball | 1 |
| 8 | GJC 27C | 3.005 | 320 9017 | RETAINER, Bearing | 1 |
| 9 | 8X-3427 | 3.005 | 320 9018 | SCREW, Bearing Retainer (#10-32 x 1/2) | 3 |
| 10 | GAR-171 | 3.005 | 320 9019 | RING, Snap | 1 |
| 11 | ALE-2006C | 3.005 | 320 9020 | ROTOR ASSEMBLY (34 Amp.) | 1 |
| 11 | ALE-2006 | 3.005 | 320 9043 | ROTOR ASSEMBLY (40 Amp.) | 1 |
| 12 | X-3470 | 3.005 | 320 9021 | SCREW, Ground Brush | 1 |
| 13 | ALE-2008D | 3.005 | 320 9022 | STATOR ASSEMBLY (34 Amp.) | 1 |
| 13 | ALE-2008 | 3.005 | 320 9044 | STATOR ASSEMBLY (40 Amp.) | 1 |
| 14 | X-3554 | 3.005 | 320 9023 | CLAMP, Stator Lead To Rectifier Wire | 3 |
| 15 | XA-944C | 3.005 | 320 9024 | DIODE, Negative | 3 |
| 16 | ALE-1002FS | 3.005 | 320 9025 | HEAD ASSEMBLY, Commutator End (34 Amp.) | 1 |
| 16 | ALE-1002AS | 3.005 | 320 9045 | HEAD ASSEMBLY, Commutator (40 Amp.) | 1 |
| 17 | 12X-196 | 3.005 | 311 3686 | LOCKWASHER, Mounting Stud Nut (#19) (Replaces 311 8964) | 2 |
| 18 | 8X-173 | 3.005 | 320 9027 | NUT, Mounting Stud (Hexagon)(#10-32) | 2 |
| 19 | X-3417 | 3.005 | 320 9028 | BEARING, Roller | 1 |
| 20 | 12X-196 | 3.005 | 311 3686 | LOCKWASHER, Thr Bolt (Replaces 311 8964) | 4 |
| 21 | ALA-20C | 3.005 | 320 9030 | BOLT, Thru | 4 |
| 22 | ALC-21D | 3.005 | 320 9031 | SPACER, Rotor Shaft (34 Amp.) | 1 |
| 22 | ALD-21 | 3.005 | 320 9046 | SPACER, Rotor Shaft (40 Amp.) | 1 |