

GROUP 4

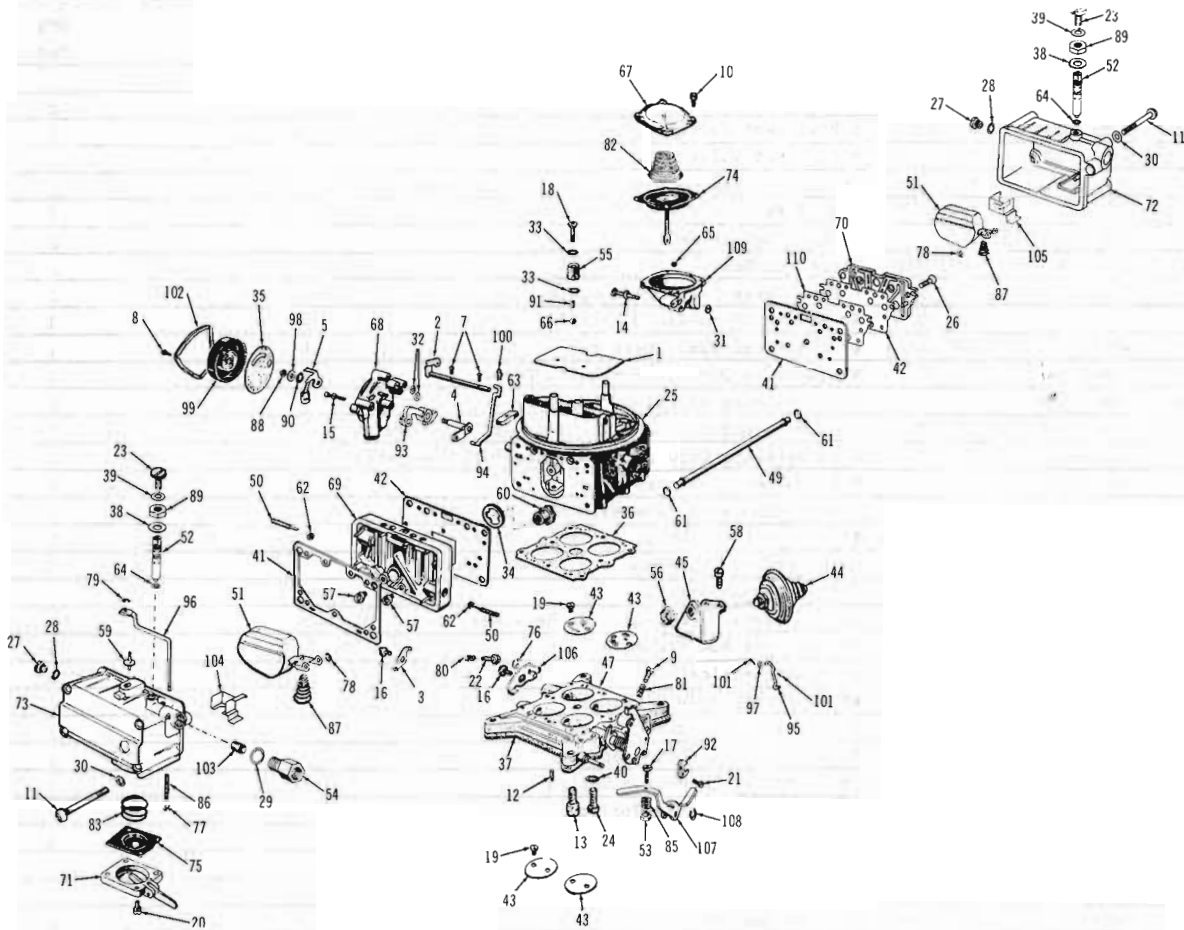

CARBURETOR 65 10-80 (V8-W4B)

A.M. NO. 320 6237 (Use For R-3201 and R-3202)

HOLLEY NO. R-3203A

| KEY NO. | HOLLEY NO. | A.M. NO. | DESCRIPTION | PER CAR |
|----------|------------|----------|---|---------|
| 85A-1111 | | 320 3586 | Assortment Kit (Includes all parts listed below which are coded with a ϕ) | |
| 85R-792 | | 320 6538 | Pep Kit (Includes all parts listed below which are coded with a #) | 1 |
| 85R-1676 | | 320 6537 | Repair Kit (Includes all parts listed below which are coded with a *) | 1 |
| 85G-1675 | | 320 6539 | *Gasket Set (Includes all parts listed below which are coded with a +) | 1 |
| 85R-1686 | | 320 6700 | Dashpot and Bracket Assy. (Includes all parts listed below which are coded with a @) | 1 |
| | | 317 0979 | Metering Jet Pkg. (Includes 2 Holley 22R-40-47 Metering Jets for 5,000 ft. Alt. and 10,000 Ft. Alt.) | 1 |
| 85D-1192 | | 320 6333 | Pump Diaphragm Kit (Includes all parts listed below which are coded with a \equiv) | 1 |
| 85S-1208 | | 320 6376 | Secondary Diaphragm Housing Assembly Kit (Includes all parts listed below which are coded with a \mathbb{W}) | 1 |
| 85B-1210 | | 320 6378 | Bowl Kit (Secondary) (Includes all parts listed below which are coded with a \mathbb{W}) | 1 |
| 85B-1211 | | 320 6374 | Bowl Kit (Primary) (Includes all parts listed below which are coded with a \mathbb{X}) | 1 |